



OPERATIONS MANUAL



POLARIS RZR® 1000 EXPEDITION RACK™
&
POLARIS RZR® 1000 SHERPA RACKS™

POLARIS RZR® 1000 EXPEDITION RACK™

PART#	DESCRIPTION
RB05100	POLARIS RZR® 1000 EXPEDITION RACK™ (2 Seat Models) (MOUNTING HARDWARE INCLUDED)



We designed our Expedition RZR Cargo Rack to take all the abuse that the Polaris RZR 1000 can dish out. The RB0 Expedition Rack™ is made from 1.5" Diameter Steel Tubing. It has a rugged powder coated finish and is manufactured by us right here in IDAHO. The Tailgate can be locked with a Pad-Lock so you can keep your possessions locked and secured from thieves. The Tailgate on our Expedition Rack has a gas strut to hold the tailgate open and out of the way. The Expedition Rack also features our "It Fits"™ RBO Mounting system. With the "It Fits"™ mounting system you can quickly and easily install any RBO accessory with the "It Fits"™ icon. Carrying a fuel can, water jug or spare tire has never been easier or cooler looking then by using the "It Fits"™ RBO Mounting system on your Expedition Rack.



Polaris RZR® 1000 Expedition Rack™ Fitment Chart

Year	Product Fitment
2015 - Present	RZR® XP 1000
2015 - Present	RZR® S 1000 EPS
2015 - Present	RZR® XP 1000 Turbo
2015 - Present	RZR® XP 1000 Turbo FOX Edition
2015 - Present	RZR® XP 1000 Ride Command Edition
2015 - Present	RZR® XP 1000 Trails and Rocks Edition

INCLUDED MOUNTING HARDWARE

- (4) - M10 - 1.5 x 70mm Flange Hex Bolt
- (4) - M10 - 1.5mm 60mm Flange Hex Bolts
- (8) - M10 - Nylock Flange Nuts
- (4) - Aluminum Spacers
- (16) - 1/4" - 20 X 3/4" Hex Flange Bolt
- (4) - 1/4" - 20 X 1" Hex Flange Bolt
- (20) - 1/4" - 20 Flange Nylock Nut
- (2) - 3/8" x 3/4" Shoulder Bolt
- (4) - 3/8" Brass Washers
- (10) - 5/16" - 18 Flange Nut
- (8) - 5/16" x 3/4" Socket Cap Screw
- (1) - T Handle

TOOLS REQUIRED FOR INSTALLATION

- 3/8" Socket / End Wrench
- 7/16" Socket / End Wrench
- 1/2" Socket / End Wrench
- 15 mm Socket / End Wrench
- (1) - 1/4" Allen Wrench (Included)

POLARIS RZR® 1000 SHERPA RACK™

PART#	DESCRIPTION
RB05099	POLARIS RZR® 1000 Sherpa RACK™ (2 Seat Models) (MOUNTING HARDWARE INCLUDED)



We call this Rack the “Sherpa” out of great respect for the people that live in the North-Eastern Part of Nepal. It’s been known for years that Sherpas have led people on great adventures helping people achieve great accomplishments. While we can’t lead everyone on an adventure, we can design products to help them on their way. We feel that our Sherpa Rack™ is a great tool that will help you on your next great adventure!

Designed to fit the 2015 thru 2018 Polaris RZR 1000 The RBO Sherpa Rack™ is made from 1.5” Diameter Steel Tubing. It has a rugged powder coated finish and is manufactured right here in IDAHO. The Sherpa Rack also has our “It Fits”™ RBO attachment mounting system. With the “It Fits”™ mounting system you can quickly and easily install any RBO accessory with the “It Fits”™ icon. This rack comes with everything you need to install it on your machine without drilling or modifying your machine.



Polaris RZR® 1000 Sherpa Rack™ Fitment Chart

Year	Product Fitment
2015 - Present	RZR® XP 1000
2015 - Present	RZR® S 1000 EPS
2015 - Present	RZR® XP 1000 Turbo
2015 - Present	RZR® XP 1000 Turbo FOX Edition
2015 - Present	RZR® XP 1000 Ride Command Edition
2015 - Present	RZR® XP 1000 Trails and Rocks Edition

INCLUDED MOUNTING HARDWARE

- (4) - M10 – 1.5 x 70mm Flange Hex Bolt
- (8) - M10 -1.5mm 60mm Flange Hex Bolts
- (8) - M10 - Nylock Flange Nuts
- (4) - Aluminum Spacers
- (14) - 1/4" - 20 X 3/4" Hex Flange Bolt
- (4) - 1/4" - 20 X 1" Hex Flange Bolt
- (18) - 1/4" - 20 Flange Nylock Nut

TOOLS REQUIRED FOR INSTALLATION

- 3/8" Socket / End Wrench
- 7/16" Socket / End Wrench
- 1/2" Socket / End Wrench
- 15 mm Socket / End Wrench
- (1) -1/4" Allen Wrench (Included)



POLARIS RZR®1000 4 EXPEDITION RACK™

PART#	DESCRIPTION
RB05116	POLARIS RZR® 1000 4 EXPEDITION RACK™ (4 Seat Models) (MOUNTING HARDWARE INCLUDED)



Polaris RZR® 1000 4 Expedition Rack™ Fitment Chart	
Year	Product Fitment
2015 - Present	RZR® XP 4 1000
2015 - Present	RZR® XP 4 Turbo
2015 - Present	RZR® XP 4 Turbo FOX Edition
2015 - Present	RZR® XP 4 Turbo DYNAMIX Edition

INCLUDED MOUNTING HARDWARE

- (4) - M10 - 1.5 x 70mm Flange Hex Bolt
- (8) - M10 - 1.5mm 60mm Flange Hex Bolts
- (8) - M10 - Nylock Flange Nuts
- (8) - M10 - Flat Washer
- (4) - Aluminum Spacers
- (16) - 1/4" - 20 X 3/4" Hex Flange Bolt
- (4) - 1/4" - 20 X 1" Hex Flange Bolt
- (20) - 1/4" - 20 Flange Nylock Nut
- (2) - 3/8" x 3/4" Shoulder Bolt
- (4) - 3/8" Brass Washers
- (10) - 5/16" - 18 Flange Nut
- (8) - 5/16" x 3/4" Socket Cap Screw
- (1) - T Handle

TOOLS REQUIRED FOR INSTALLATION

- 3/8" Socket / End Wrench
- 7/16" Socket / End Wrench
- 1/2" Socket / End Wrench
- 15 mm Socket / End Wrench
- (1) - 1/4" Allen Wrench (Included)



POLARIS RZR®1000 4 SHERPA RACK™

PART#	DESCRIPTION
RB05115	POLARIS RZR® 1000 4 Sherpa RACK™ (4 Seat Models) (MOUNTING HARDWARE INCLUDED)



Polaris RZR® 1000 4 Sherpa Rack™ Fitment Chart	
Year	Product Fitment
2015 - Present	RZR® XP 4 1000
2015 - Present	RZR® XP 4 Turbo
2015 - Present	RZR® XP 4 Turbo FOX Edition
2015 - Present	RZR® XP 4 Turbo DYNAMIX Edition

INCLUDED MOUNTING HARDWARE

- (4) - M10 – 1.5 x 70mm Flange Hex Bolt
- (8) - M10 -1.5mm 60mm Flange Hex Bolts
- (8) - M10 - Nylock Flange Nuts
- (4) - Aluminum Spacers
- (14) - 1/4" - 20 X 3/4" Hex Flange Bolt
- (4) - 1/4" - 20 X 1" Hex Flange Bolt
- (18) - 1/4"- 20 Flange Nylock Nut

TOOLS REQUIRED FOR INSTALLATION

- 3/8" Socket / End Wrench
- 7/16" Socket / End Wrench
- 1/2" Socket / End Wrench
- 15 mm Socket / End Wrench
- (1) -1/4" Allen Wrench (Included)

Installation Instructions

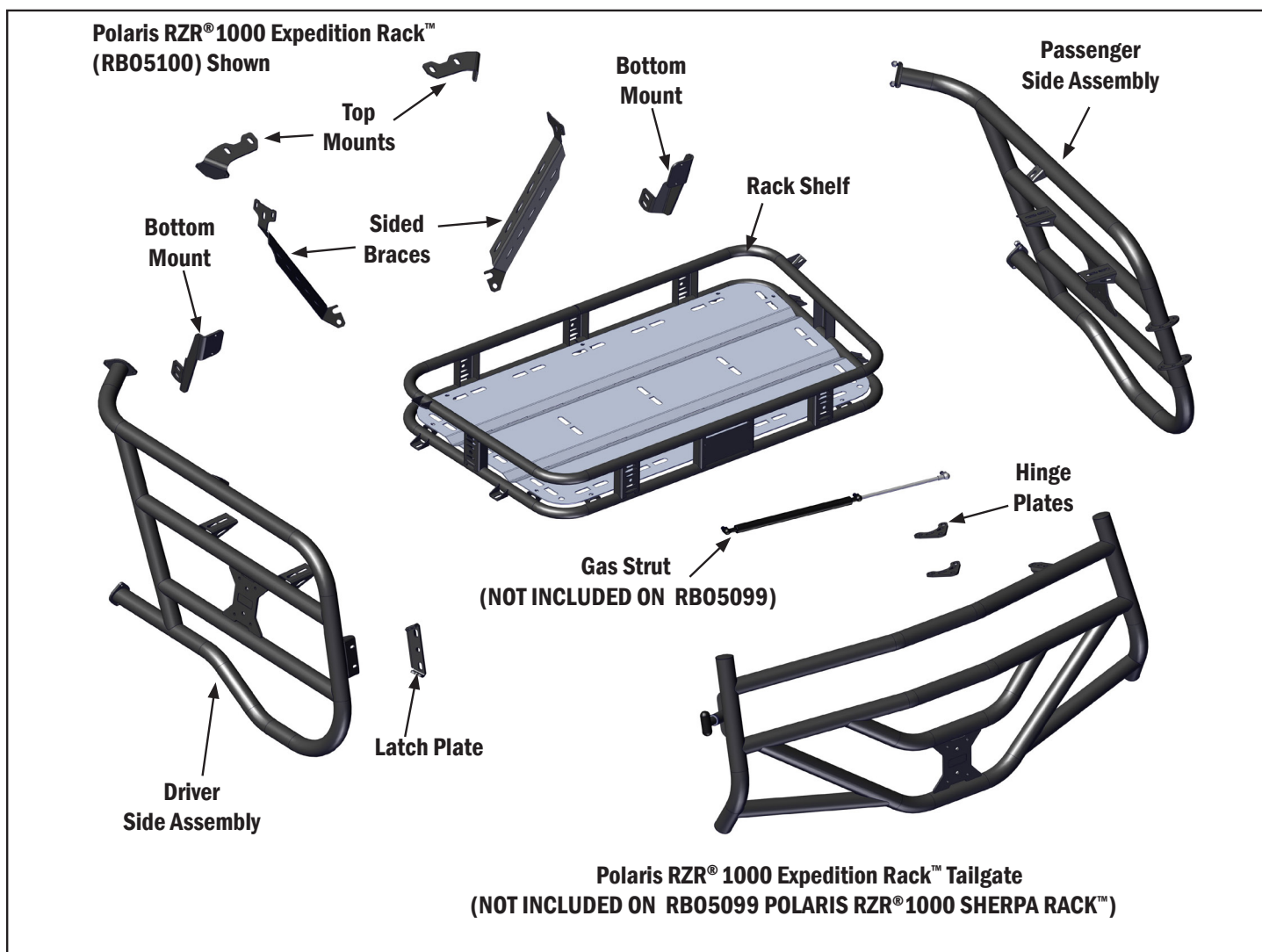

Install Top Mounting Brackets

(**RB05100 & RB05099, 2 Seat Models**)

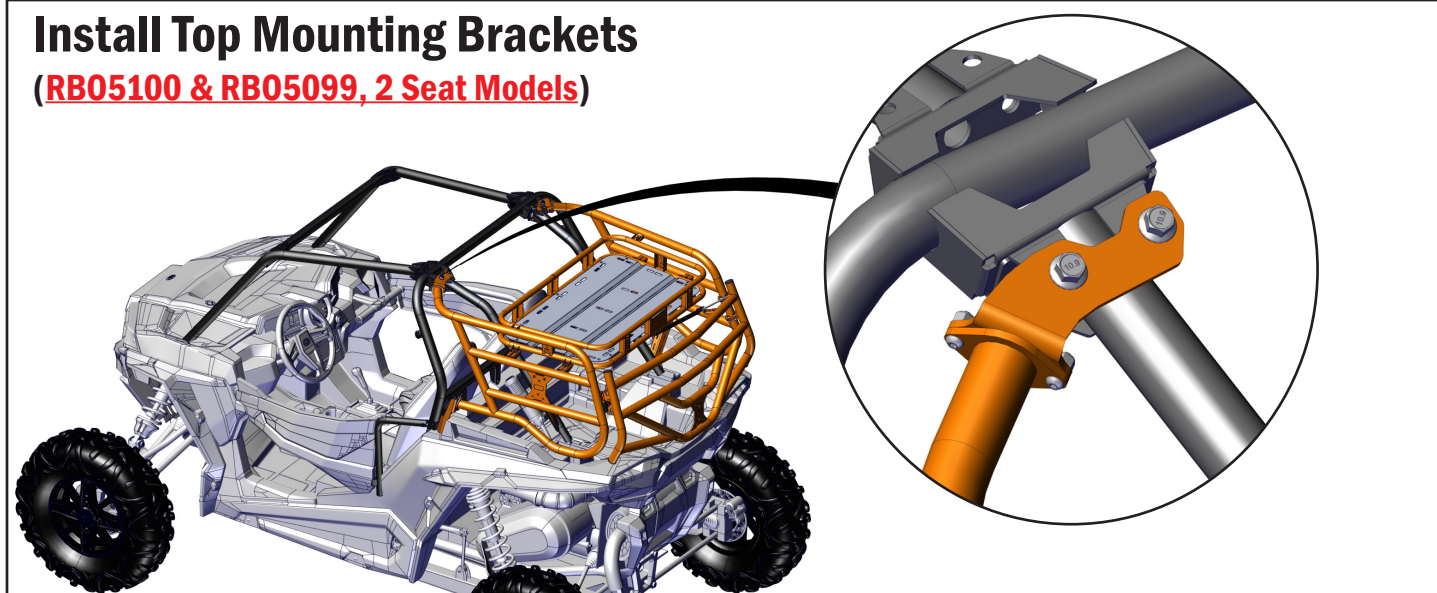

- Align aluminum spacers with the top mounting holes of the vehicle. Fig. 1-1

- Install the Top Mounting Brackets using

(2) - M10 – 1.5 x 70mm Flange Hex Bolt



(2) - Aluminum Spacers



(2) - M10 – 1.5 Nylock Nuts



See Fig. 1-2

- Leave the brackets loose so that you can make adjustments in the installation in future steps

- Repeat for opposite side. See Fig. 1-3 to 1-6

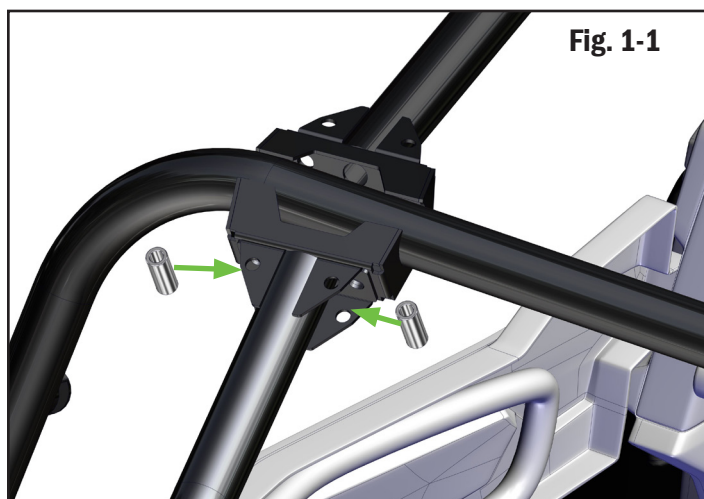

Fig. 1-1

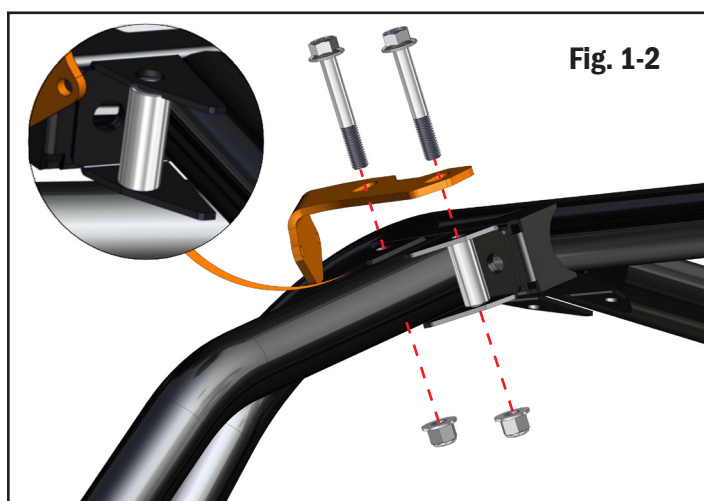

Fig. 1-2

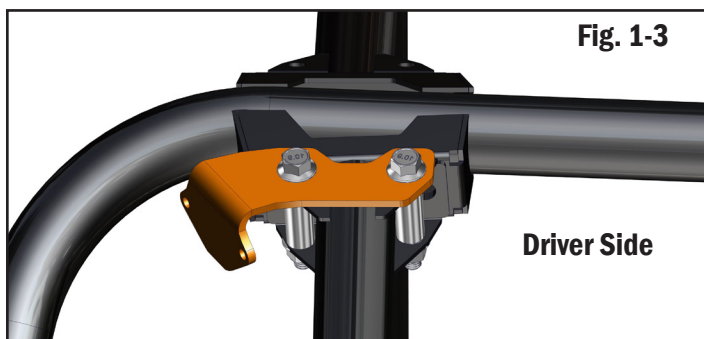

Fig. 1-3

Driver Side

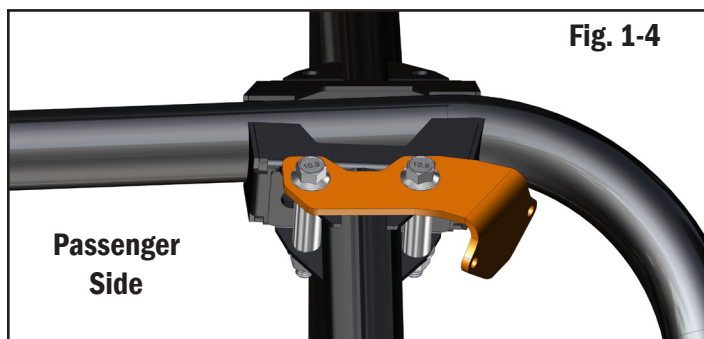

Fig. 1-4

Passenger Side

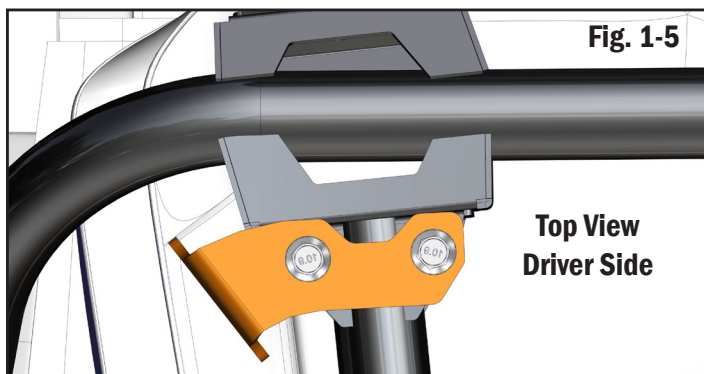

Fig. 1-5

Top View Driver Side

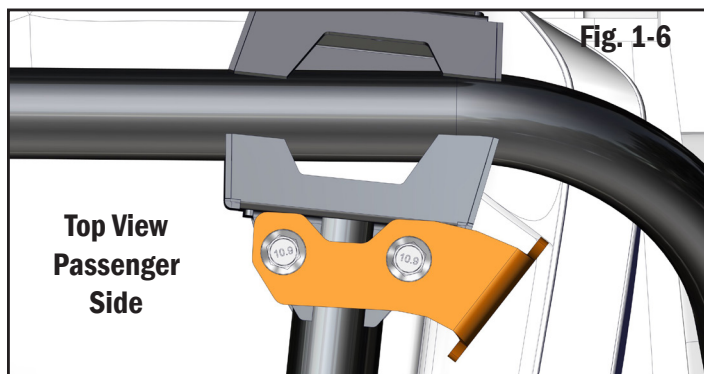
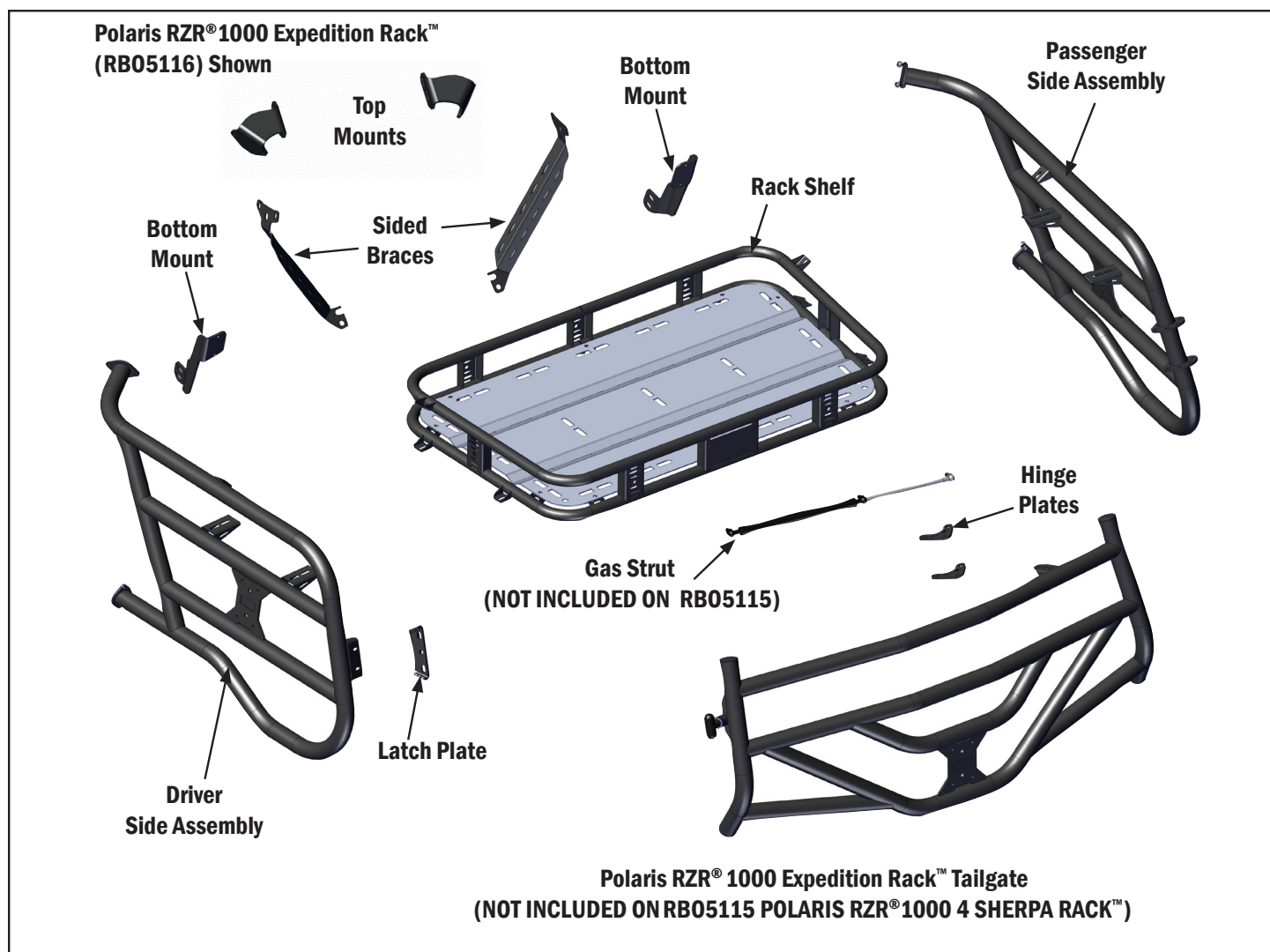

Fig. 1-6

Top View Passenger Side

Installation Instructions



Install Top Mounting Brackets

(**RB05116 & RB05115, 4 Seat Models**)

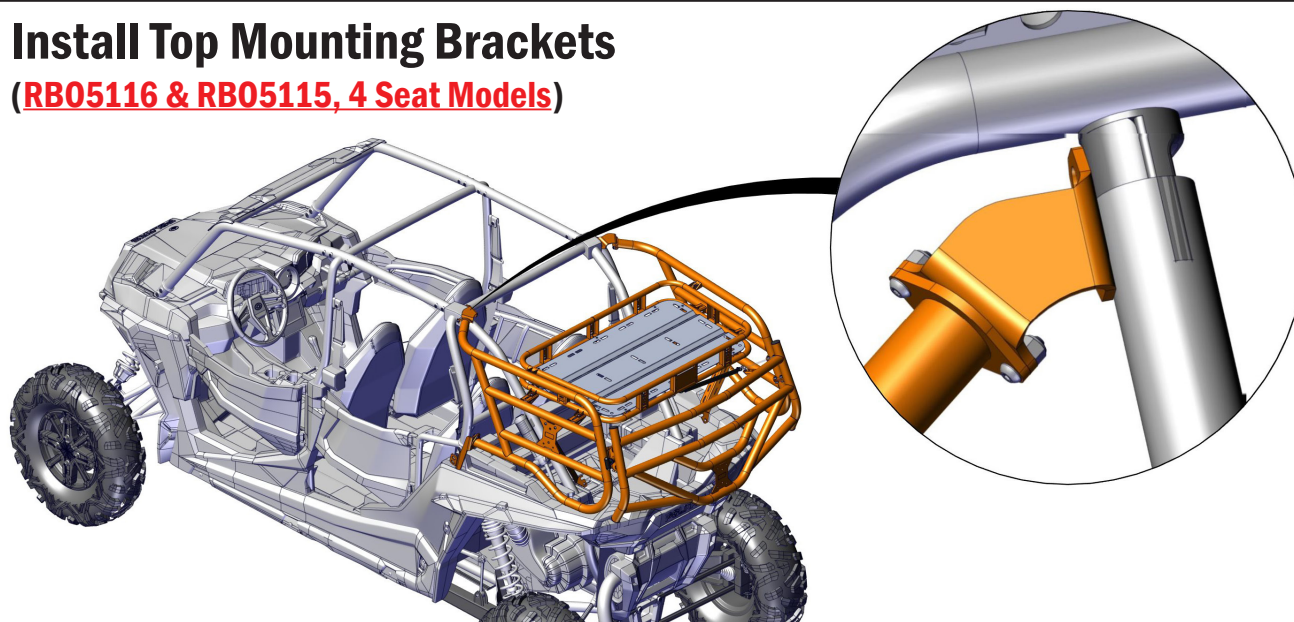

- Use Flat Washers as a shim for the Top mounting brackets as seen in Fig. 1-7 and Fig. 1-8

-RBO provides (8) - M10 - Flat Washers, but it is up the installer to determine if the top mounting brackets have been properly mounted

- Install the Top Mounting Brackets using the vehicles preexisting mounting nuts and

(2) - M10 - 1.5 x 60mm Flange Hex Bolts

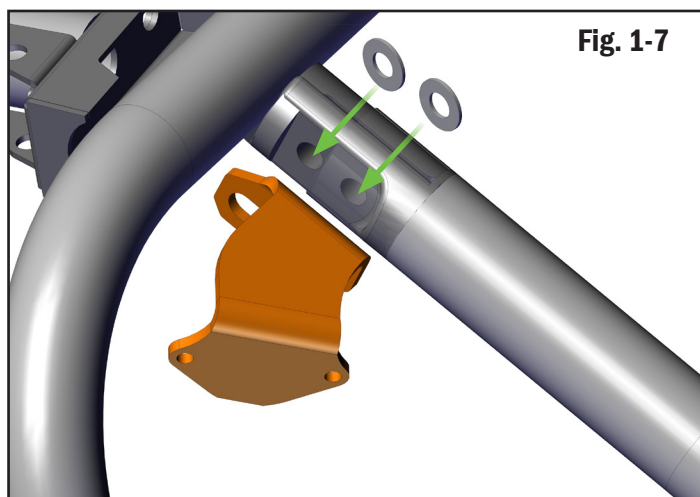

Fig. 1-7

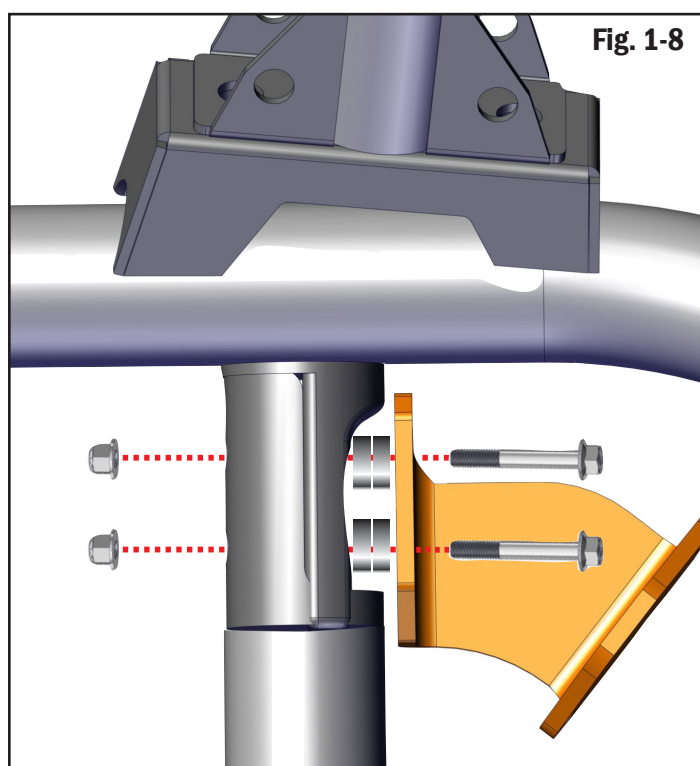

Fig. 1-8



Fig.1-9

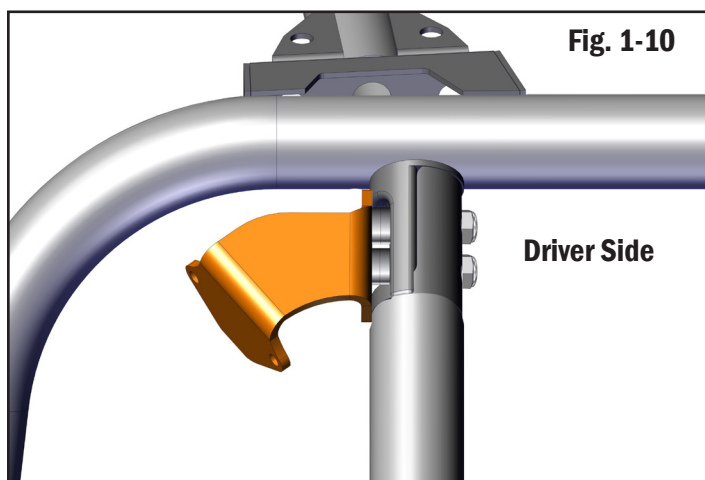

Fig. 1-10

Driver Side

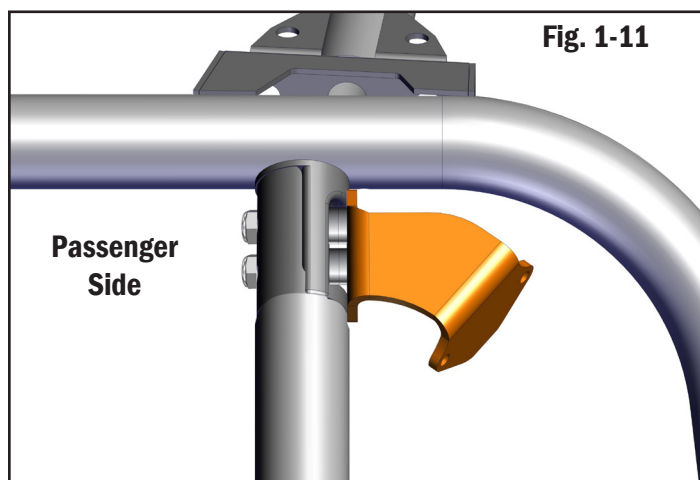

Fig. 1-11

Passenger Side

Install Side Mounting Brackets

- Remove factory installed bolts from ROPS side mounting locations

- Install the Side Mounting Brackets using

(2) - M10 - 1.5mm 60mm Flange Hex Bolts



(2) - M10 - 1.5 Nylock Nuts



- Leave the brackets loose so that you can make adjustments in the installation in future steps

- Repeat for opposite side.

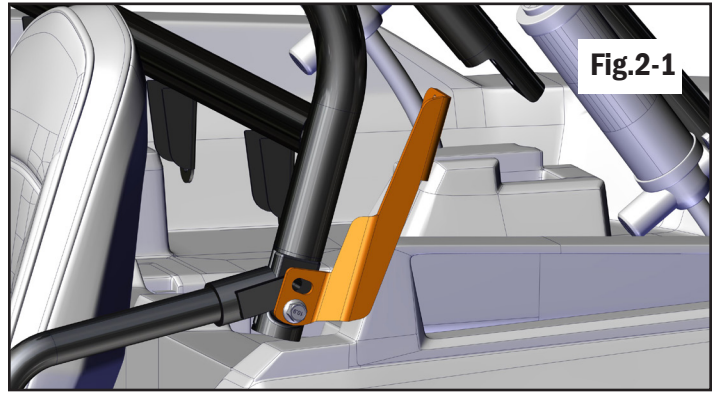

Fig. 2-1



Fig. 2-2

Install Side Braces

- From the back ROPS mounting location, loosen the top mounting bolt and remove the bottom mounting bolt
See Fig. 3-1

- Install Side Braces using factory bolts. Re-install the bottom factory bolt into lower Side Brace mounting hole
See Fig. 3-2

- Leave the brace loose so that you can make adjustments in the installation in future steps

- Repeat for opposite side

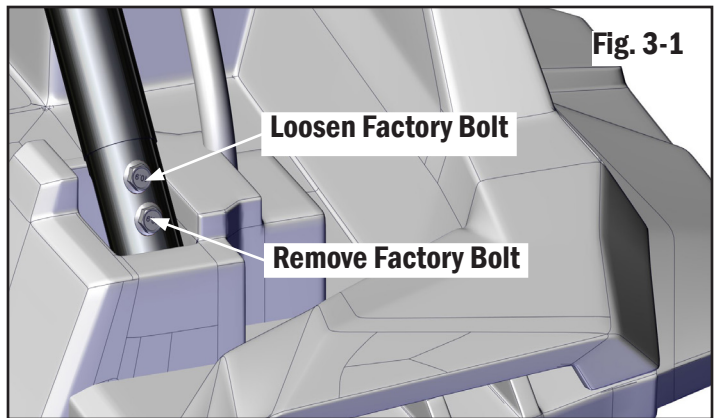

Fig. 3-1



Fig. 3-2

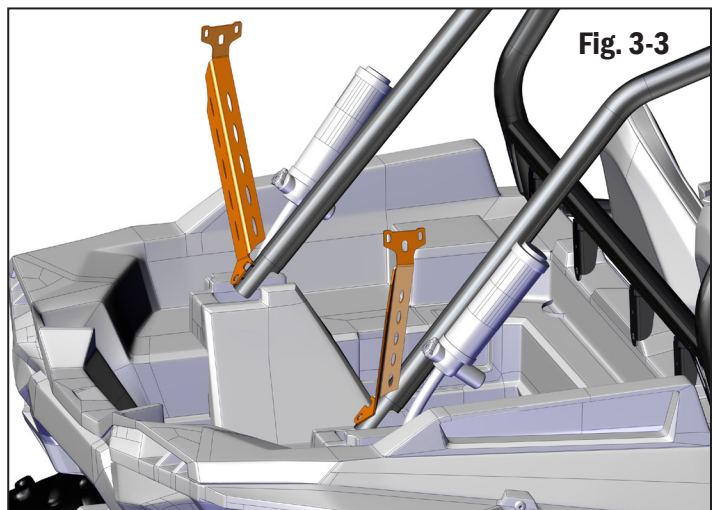
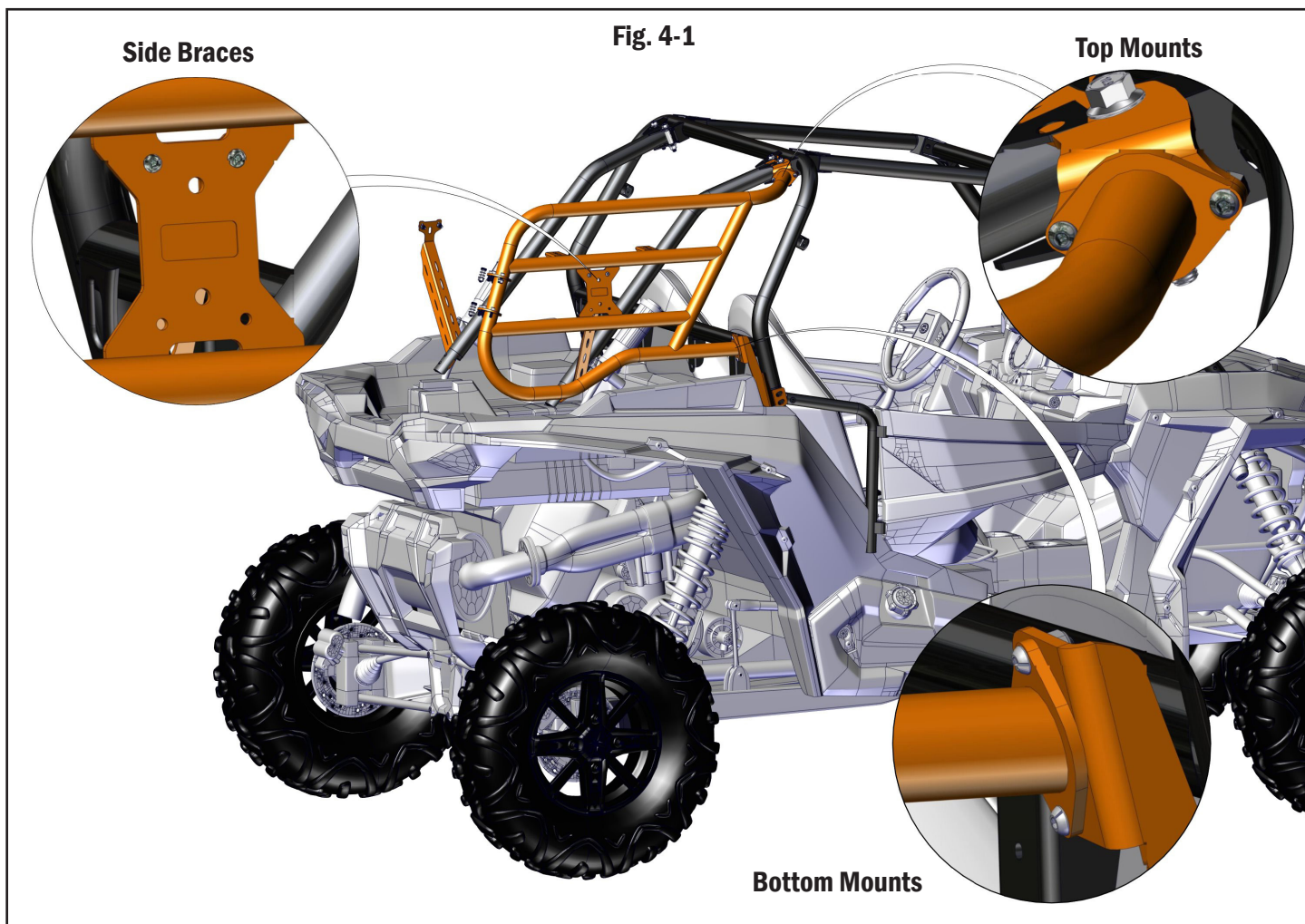

Fig. 3-3

Install Rack Sides

- The Rack Sides mount to both the Top and Bottom Mounts as well as the Side Braces. See Fig. 4-1 for a overview of installation points



- RBO recommends mounting the Side Brace point first. It will hold the Rack Side in place, making the installation on the Top and Bottom mounts easier.

- Install the Rack Side to the Side Brace using
(2) - 1/4" - 20 X 1" Hex Flange Bolt



(2) - 1/4" Nylock Flange Nut



See Fig. 4-2

- Install the Rack Side to the Top Mount using
(2) - 1/4" - 20 X 3/4" Hex Flange Bolt



- (2) - 1/4" Nylock Flange Nut



See Fig. 4-3 and 4-4

- Leave the brace loose so that you can make adjustments in the installation in future steps

- Repeat for opposite side

- Install the Rack Side to the Bottom Mount using
(2) - 1/4" - 20 X 3/4" Hex Flange Bolt



- (2) - 1/4" Nylock Flange Nut



See Fig. 4-5

- Leave the brace loose so that you can make adjustments in the installation in future steps

- Repeat for opposite side



Fig. 4-3



Fig. 4-4



Fig. 4-5



Fig. 4-6

Install Basket

- Install the Rack Side to the Top Mount using
(6) - 1/4" - 20 X 3/4" Hex Flange Bolt



- (6) - 1/4" Nylock Flange Nut



See Fig. 5-1 and 5-4 for mounting locations

- Tighten all bolts from previous steps. Some adjustments to components may need to be made, making sure that Rack sides and Rack even on vehicle.

- Tighten the upper mount points on the rack, then tighten the lower mount points.

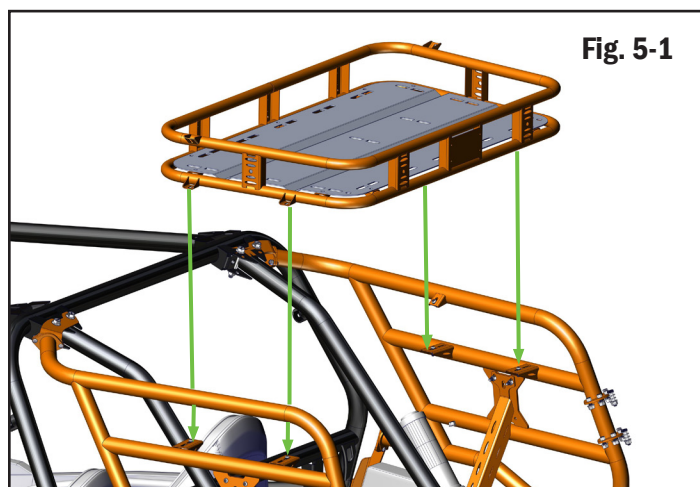

Fig. 5-1

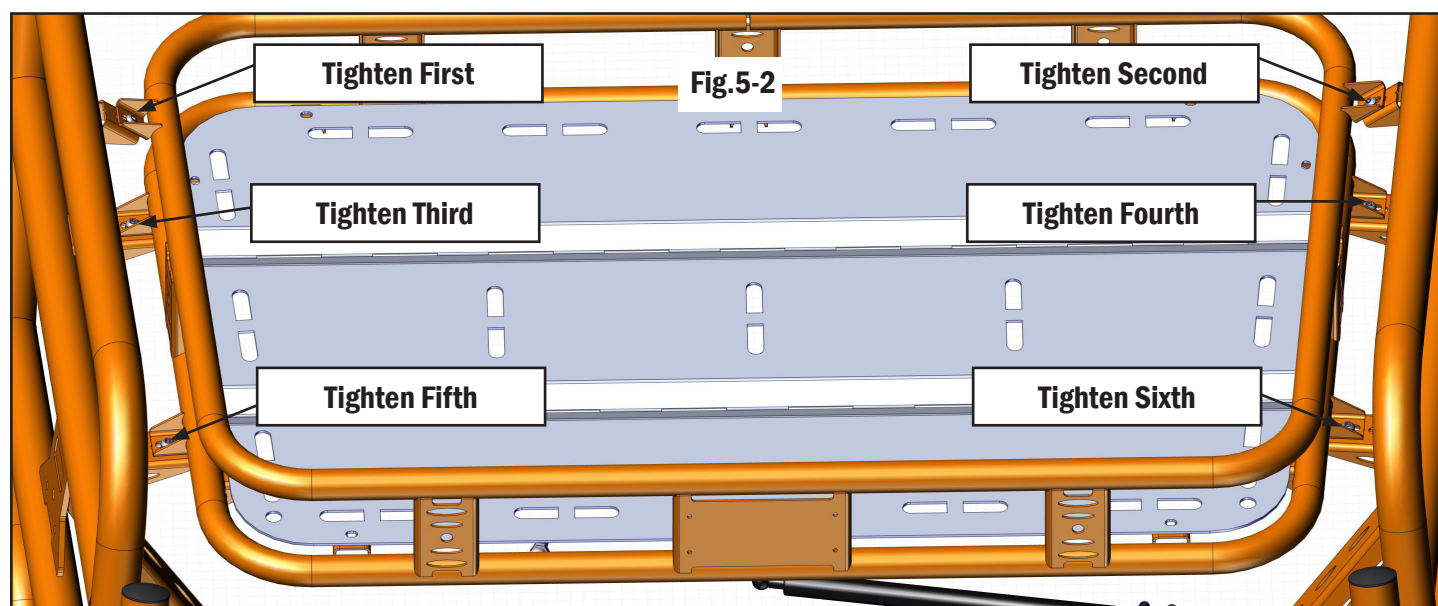

Fig.5-2



Fig.5-3

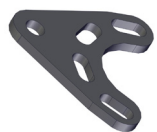

Fig.5-4



Install Tailgate

(Not included on Sherpa models, RB05099 & RB05115)



(RB05084) Hinge Bracket



(2) - 3/8" Shoulder Bolts



(4) - 3/8" Brass Washers



(2) - 5/16" - 18 Flange Nut

-Install Polaris RZR® 1000 Expedition Rack™ (RB05100) "Tailgate" hinges using



-(8) 5/16" X 3/4" Socket Cap



-(8) 5/16" - 18 Flange Nut

-Do not fully tighten, keep the "Tailgate" hinges slightly loose. This will give a little play with installation on unit

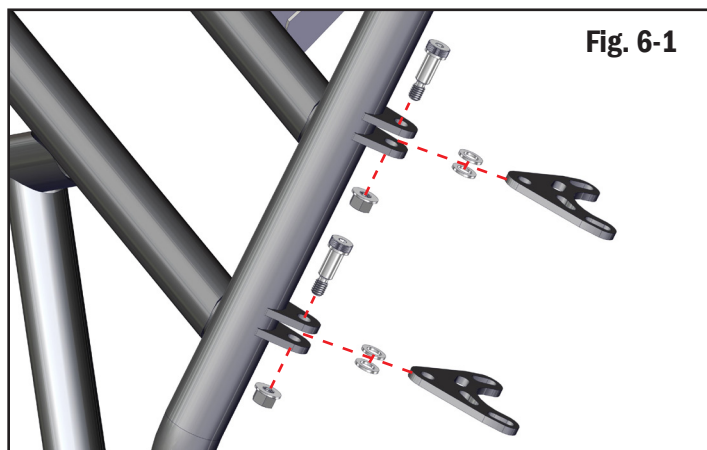

Fig. 6-1



Fig. 6-2

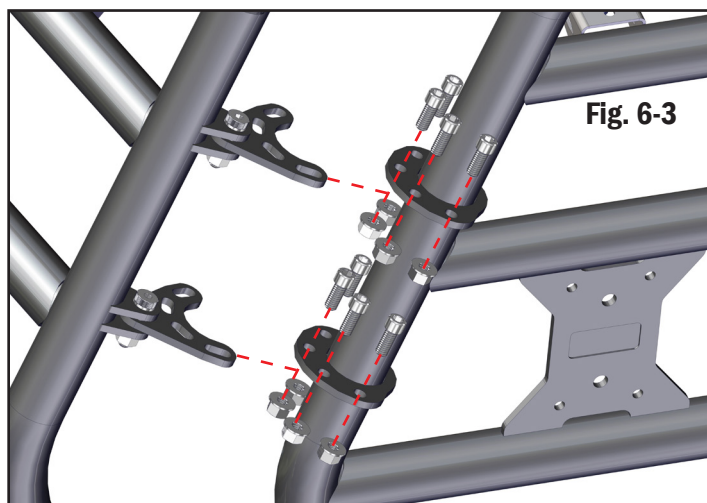

Fig. 6-3



Fig. 6-4

! WARNING !

- Loading Heavy Items on the Rack will change the vehicles "Center of Gravity" (C.G.) that could increase the potential for roll over which could result in serious injury or death

- Maximum Combined Capacity of Cargo Rack is 120 lbs. - 160 lbs. (Limited by Vehicle Capacity)

- Load Capacity of Top Rack is 60 lbs. (Limited by Vehicle Capacity)

- Load Capacity of Side Rack is 30 lbs. per side (Do Not Recommend Mount Spare Tires on Side Racks)

- For Racks with a Tailgate the Load Capacity of the tailgate is 40 lbs. (Limited by Vehicle Capacity)

-Install Threaded T-Handle into latch barrel on 'Tailgate'

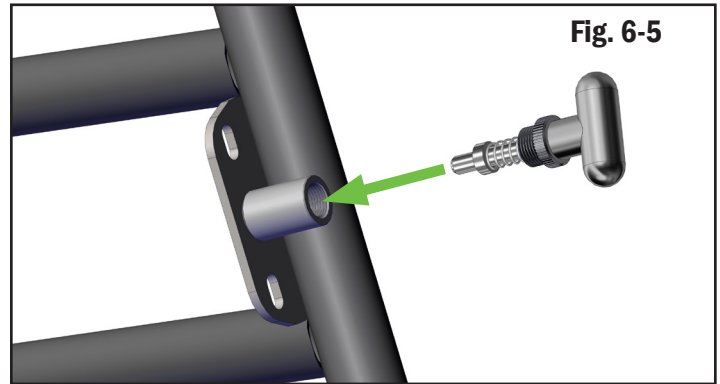

-Install latch plate using

(2) - 1/4" - 20 X 3/4" Hex Flange Bolt



(2) - 1/4" Nylock Flange Nut



See Fig. 6-6 and 6-7

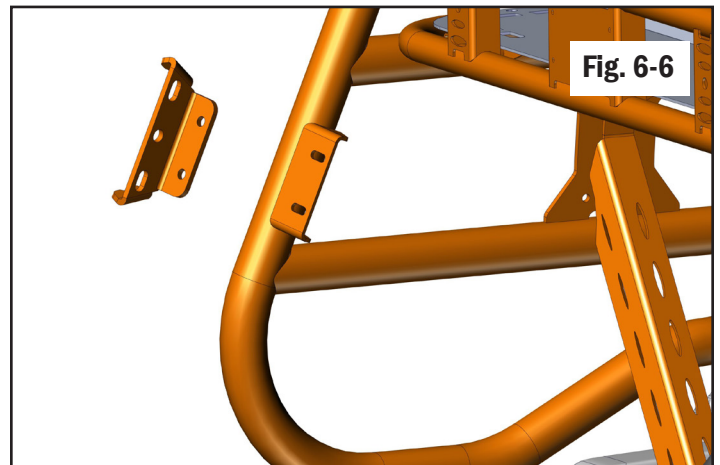

-Close and latch the "Tailgate"

-Some adjustment may needed to be made to the Tailgate hinge bolt and the latch plate bolt to make sure Tailgate securely closes.

-With the tailgate hinges it is a good idea to adjust them to compensate for the weight of a spare tire, and the verify that the tailgate securely latches close.



-Tighten all the hinge bolts and latch plate bolts

- (Optional) Use a small amount of grease on any connection point to eliminate any unwanted noises while in use

-Install Gas Strut on to the “Tailgate” mounting bracket
Fig. 13



-Close and latch the “Tailgate”

-Tighten all the hinge bolts

- Inspect the entire rack installation to verify that you have tightened all hardware

WARNING

- The Polaris RZR®1000 Expedition Rack™ (RB051000) “Tailgate” has been designed for the user push the “tailgate” shut. Do not slam it shut
- Before Transporting Flammable Liquids Please Read and Understand your Vehicles Owners Manual
- Operator must follow your vehicle manufactures warnings regarding fuel transportation
- Only Use Containers Approved For Off-road Use
- Make Sure Containers are Secured to Avoid Spills and Leaks
- Failure to Follow Proper Instructions could lead to Burn Injury and other potential Fire Hazards
- Be Sure To Comply with All Laws and Warnings Regarding the Safe Handling Of Flammable Liquids
- When In Doubt - Consult Your Local Fire Department
- Don't Take Risk “Center of Gravity” C.G. that could increase the potential for Roll Over
- It Is The Operators Responsibility to follow all manufactures recommendations regarding safe operation of the vehicle

“It Fits™” Mounting System

With the “It Fits™” mounting system you can quickly and easily install any RBO accessory with the “It Fits™” icon. These racks come with everything you need to install it on your machine without drilling or modifying your machine.



The Polaris RZR® 1000 Sherpa Racks™ (RB05099 and RB05115) have two “It Fits™” mounting locations, one on each of the side assemblies.

The Polaris RZR® 1000 Expedition Racks™ (RB05100 and RB05116) have three “It Fits™” mounting locations, one on each of the side assemblies, and one on the gate, used for spare tire.

WARNING

-That by adding mounts to the side of the vehicle you make it wider. RBO Highly recommends that you only use (RB01018) Spare Tire Mount on the (RB05100) Polaris RZR® 1000 Expedition Rack™ tailgate location.

-Be Sure To Comply with All Laws and Warnings Regarding the Safe Handling Of Flammable Liquids.

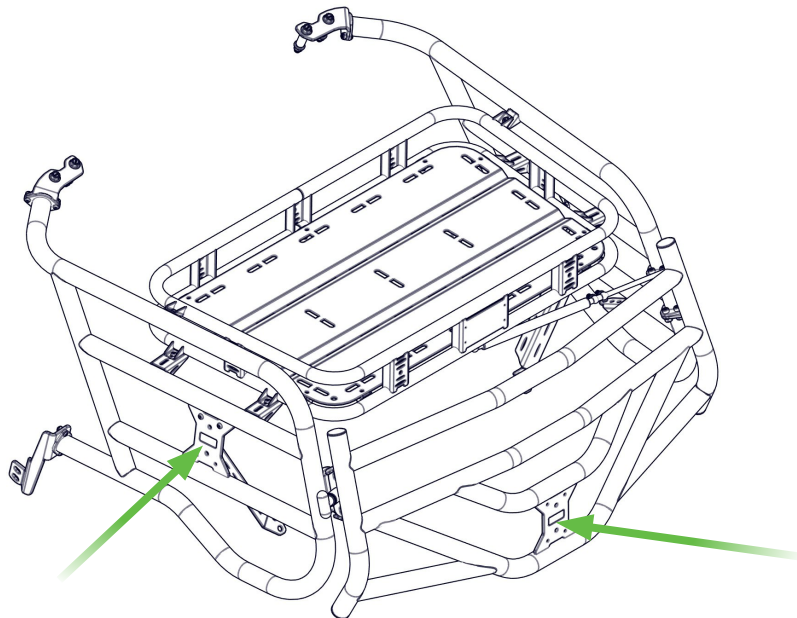
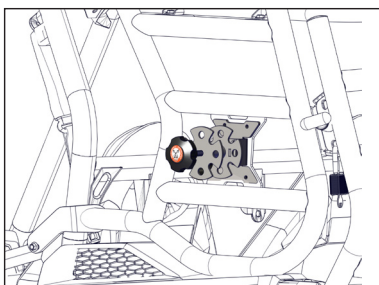
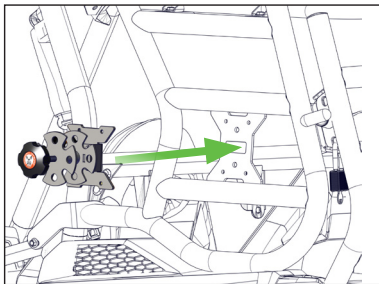

Warning: That by adding mounts to the side of the vehicle you make it wider. RBO Highly recommends that you only use (RB01018) Spare Tire Mount on the (RB051000) Polaris RZR® 1000 Expedition Rack™ tailgate location. Be Sure To Comply with All Laws and Warnings Regarding the Safe Handling Of Flammable Liquids.



PH: (208) 696-7230 FAX: (208) 580-1900

inventive edge, LLC 3190 industrial way, Mountain Home, ID 83647



RB00066R2