



# OPERATIONS MANUAL



**POLARIS RZR® 900/1000  
FOLDING FRONT WINDSHIELD**

## RZR 900/1000 FRONT FOLDING WINDSHIELDS

PART#	DESCRIPTION
RB04000	RZR 900 FRONT FOLDING WINDSHIELD W/VENTS AND WIPER (MOUNTING HARDWARE INCLUDED)
RB04021	RZR 900 FRONT FOLDING WINDSHIELD W/ WIPER (MOUNTING HARDWARE INCLUDED)
RB04022	RZR 900 FRONT FOLDING WINDSHIELD W/VENTS (MOUNTING HARDWARE INCLUDED)
RB04023	RZR 900 FRONT FOLDING WINDSHIELD (MOUNTING HARDWARE INCLUDED)

Our fold down windshield has been in the works for quite a while now. We worked hard to build the absolute best fold down windshield on the market.

We built the windshield frame from 1/8" thick 6061 Aluminum. This design is super lightweight and gives the strength to withstand years of off-road abuse.

We design this windshield to have the largest viewing of any other fold-down windshield on the market.



Polaris RZR® 900/ 1000 Front Folding Windshields Fitment Chart	
Year	Product Fitment
2015 - Present	Polaris RZR® 900
2015 - Present	Polaris RZR® 900
2015 - Present	Polaris RZR® 900 Trail
2015 - Present	Polaris RZR® 900-S
2015 - Present	RZR® 1000
2015 - Present	RZR® 1000-S
2015 - Present	RZR® 1000 XP
2015 - Present	RZR®1000 Turbo
2015 - Present	RZR® 4 900
2015 - Present	RZR® 4 1000
2014	RZR®900 XP



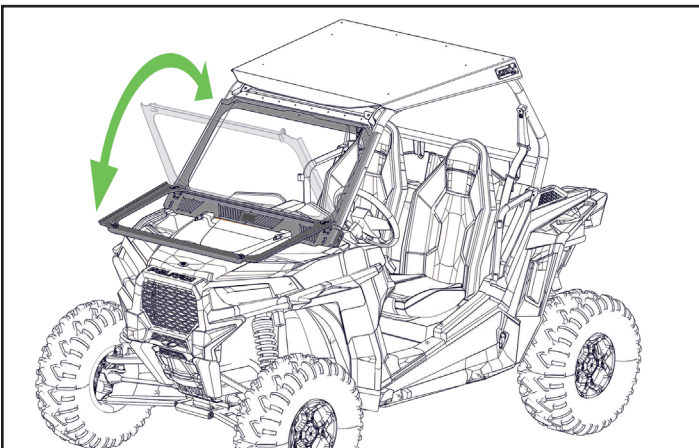

**⚠ WARNING ⚠**

**Always secure the  
Front Folding Windshield  
in the upright and locked position  
during transport**

### INCLUDED MOUNTING HARDWARE

- (10) 1/4" - 20 Flange Nylock Nut
- (10) 1/4" Stainless Steel Nylock Nut
- (10) 1/4" - 20 x 3/4" Hex Flange Bolt
- (14) 1/4" Washer
- (10) 1/4" x 1" Stainless Steel Truss Head Screw
- (2) M10mm - 1.5 x 60mm Flange Hex Bolt
- (1) 42" "Trimlock" Rubber Gasket

### REQUIRED TOOLS FOR INSTALLATION

- Phillips Screwdriver
- 15mm END WRENCH / SOCKET
- 9/32" Drill Bit
- 7/16" END WRENCH / SOCKET
- 3/8" END WRENCH / SOCKET
- T40 Torque Bit

# Installation Instructions

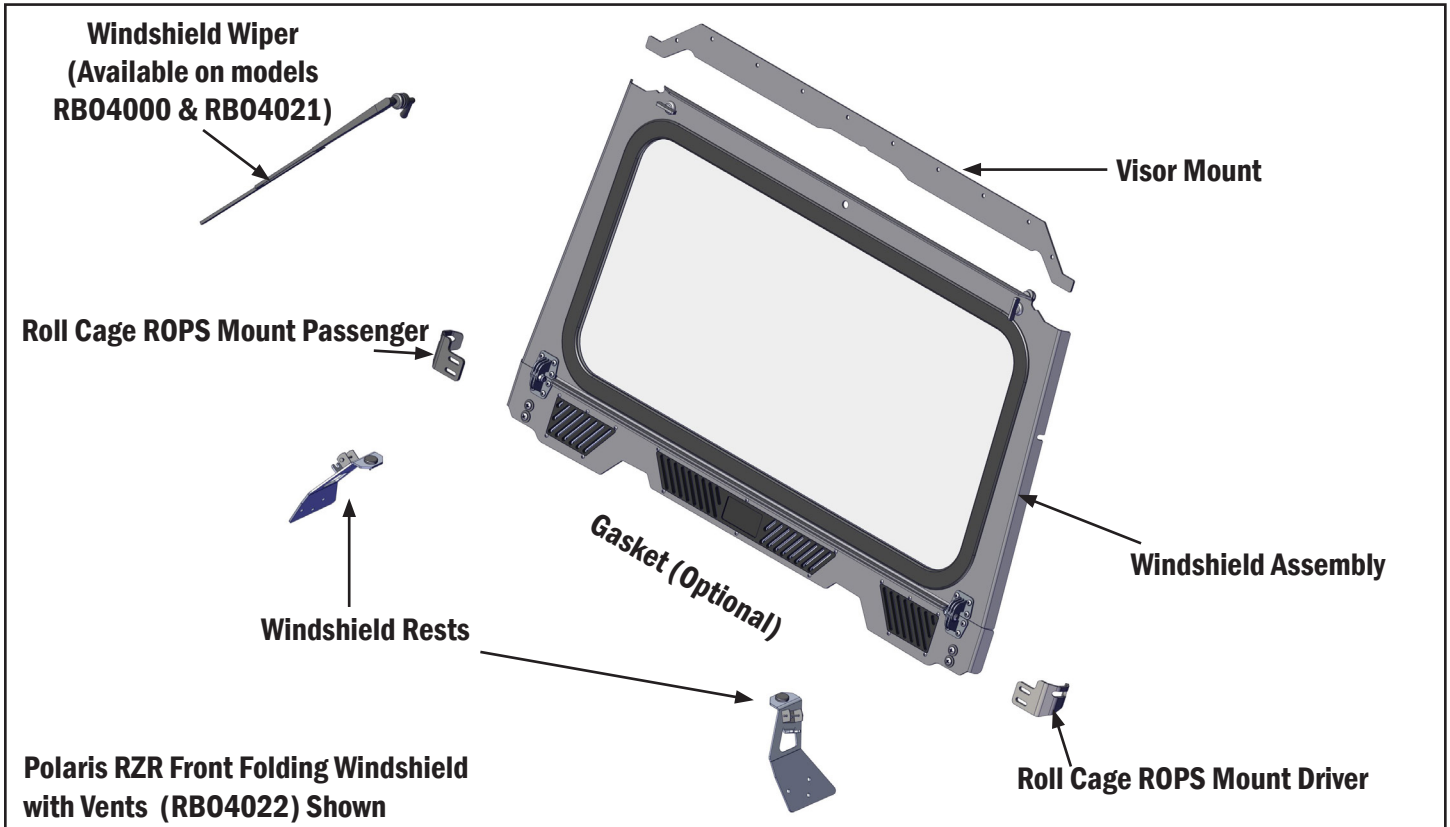

The following are general instructions for installation of the RZR 900/ 1000 FRONT FOLDING WINDSHIELDS, covering models (RB04000, RB04021, RB04022, RB04023). It is up to the installer that each window is securely mounted.

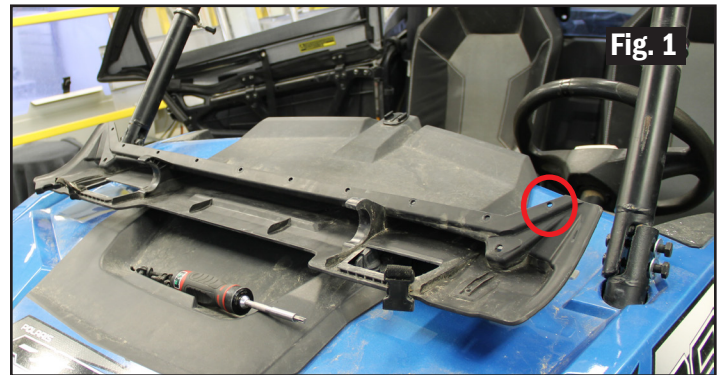

ATTENTION

Factory visor required for proper installation of the windshield

1. Drill the stock visor with a 9/32" drill bit using the "Visor Mount" as a drill template starting at the small divot as an index point. (See Fig.1)
2. Install the "Visor Mount" on to the stock visor using the 1/4" - 20 Flange Nylock Nuts and 1/4" - 20 x 3/4" Hex Flange Bolts. Reinstall the stock visor on to your unit. (Fig. 2)





**3. Remove the bottom stock 15mm bolts from the front mounting brackets of the units roll cage. Leave the top 15mm mounting bolt installed to keep roll cage from springing out of alignment. Install Roll Cage ROPS Mounts with Using M10mm - 1.5 x 60mm Flange Hex bolts and stock nut. (Fig.3)**

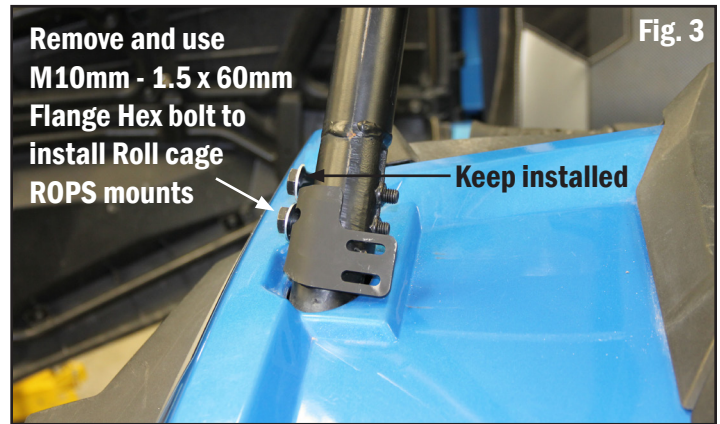

**Fig. 3**

**Additional Gasket Alternate Option:**

An additional gasket can be adhered onto the hood in order to provide an enhanced seal. If desired, this gasket must be attached before completing step 5.

**1A. Loosely install the windshield following Step 4's installation instructions.**

**2A. Once loosely in place use a dry erase marker and draw along the bottom of the vent panel onto the hood of the RZR. Once the line is drawn, remove the window. (Fig. 3a)**



**Fig. 3a**

**3A. Partially remove backing at one end of the gasket and carefully adhere the gasket into place using the drawn line to guide placement. (Trim off any excess once the gasket is set). (Fig. 3b)**

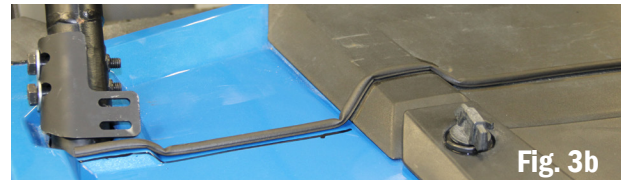

**Fig. 3b**

**4A. Follow steps 4-5 to finish.**

**4. Loosely install front windshield into place. Using 1/4" x 1" Stainless Steel Truss Head Screws and Stainless Steel Nylock Nuts.**

**- Center the windshield and secure the two top locks in place. (Fig. 4)**



**Fig. 4**

**5. Push down on windshield frame to ensure a tight seal with the bottom of windshield and the hood.**

**- Tighten all mounting bolts and hardware. (Fig 5)**



**6. Remove Star head bolt (T40 Torx Bit) from the vehicles front hood on both sides. (Fig. 6a - 6b)**

**-From the backside of the fender, remove the bolt clip.**

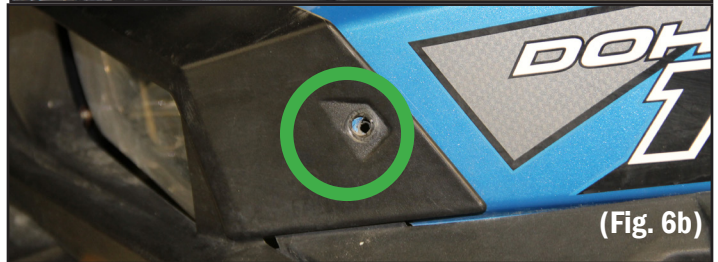
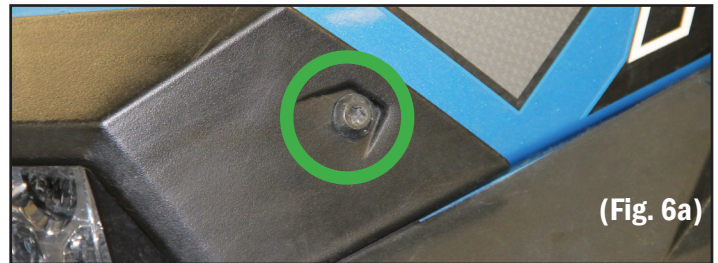

**6a. Install windshield rest into the front hood mounting hole using a 1/4" x 1" SS Trusshead Screw, and 1/4" SS Nylocks and 1/4" Washers on the inside of the hood. (Fig. 6c)**



**Fig. 6c**



7. Using the Windshield rest as a drill template, carefully drill the other mounting hole locations after first aligning the angle of the rest with the hood's decals as show by the green lines in the photo. (Fig. 7)

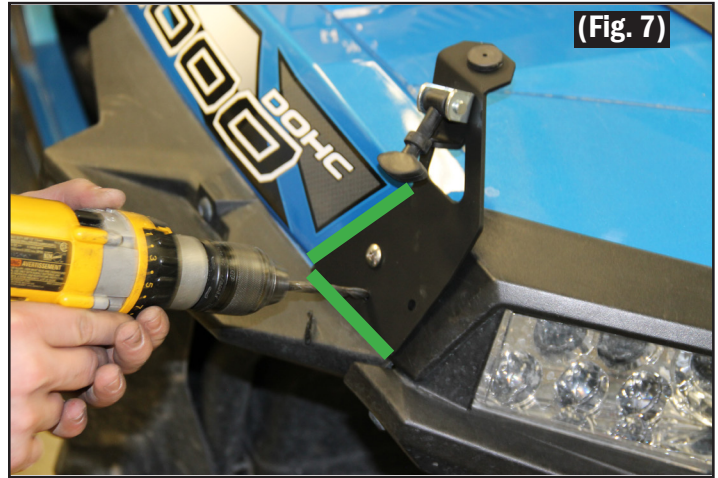

8. Finish installing windshield rest with included hardware. (Fig. 8)

**1/4" x 1" SS Trusshead Screw**  
**1/4" SS Nylocks**  
**1/4" Washers**



9. Test windshield for proper fit on the rest. (Fig. 9)



## FEATURES:

With the RBO Fold Down Windshield you get lots of choices. Imagine heading out on the trail in the morning on a fall day and its cold. You can keep the windshield up. As the sun comes up and gets warmer you can start opening vents. As it gets into late afternoon and the sun is high just lay the windshield down.



## Hinges & the Folding Windshield

Rust Free Hinges that work. Seems simple doesn't it? Use hinges that don't rust and that will work time after time.

We spent weeks testing hinges and could not find any that performed the way we wanted them so our team designed our own hinges. We make these from Stainless steel and give them a 10 year warranty. (Fig. 10 a-b)





## Twist Lock Latches

**Easy to Open** We wanted an easy open windshield that did not have pins or clips that you could lose out on the trail. That's why we spent the extra effort to design in twist lock latches. (Fig 11 a-b)



## Locking Windshield Rests

Few things are more annoying on the trail than rattles and things bouncing around. That's why we designed a stable and reliable system for holding the windshield down.

We found inspiration when we looked at the older CJ Jeeps. We used tried and true Rubber Hood Latches as our windshield Tie Downs. (Fig. 12 a-b)



## MODEL SPECIFIC FEATURES:

### Windshield Wiper

(Available on models RB04000 & RB04021)

To Give our customers more choices we offer an optional windshield wiper. We chose the manually operated wiper so you don't have to run any electrical wires. (Fig 12.a-b)



### Individually Controlled Vents

(Available on models RB04000 & RB04022)

This is another feature we are very proud of. We design 4 individual vents in the windshield each with its own opener. Now you and your passenger can decide how much airflow you want in the cab. (Fig 14.a-b)





# Dimensions

## Polaris RZR Front Folding Windshield with Wiper and Vents (RB04000) Shown

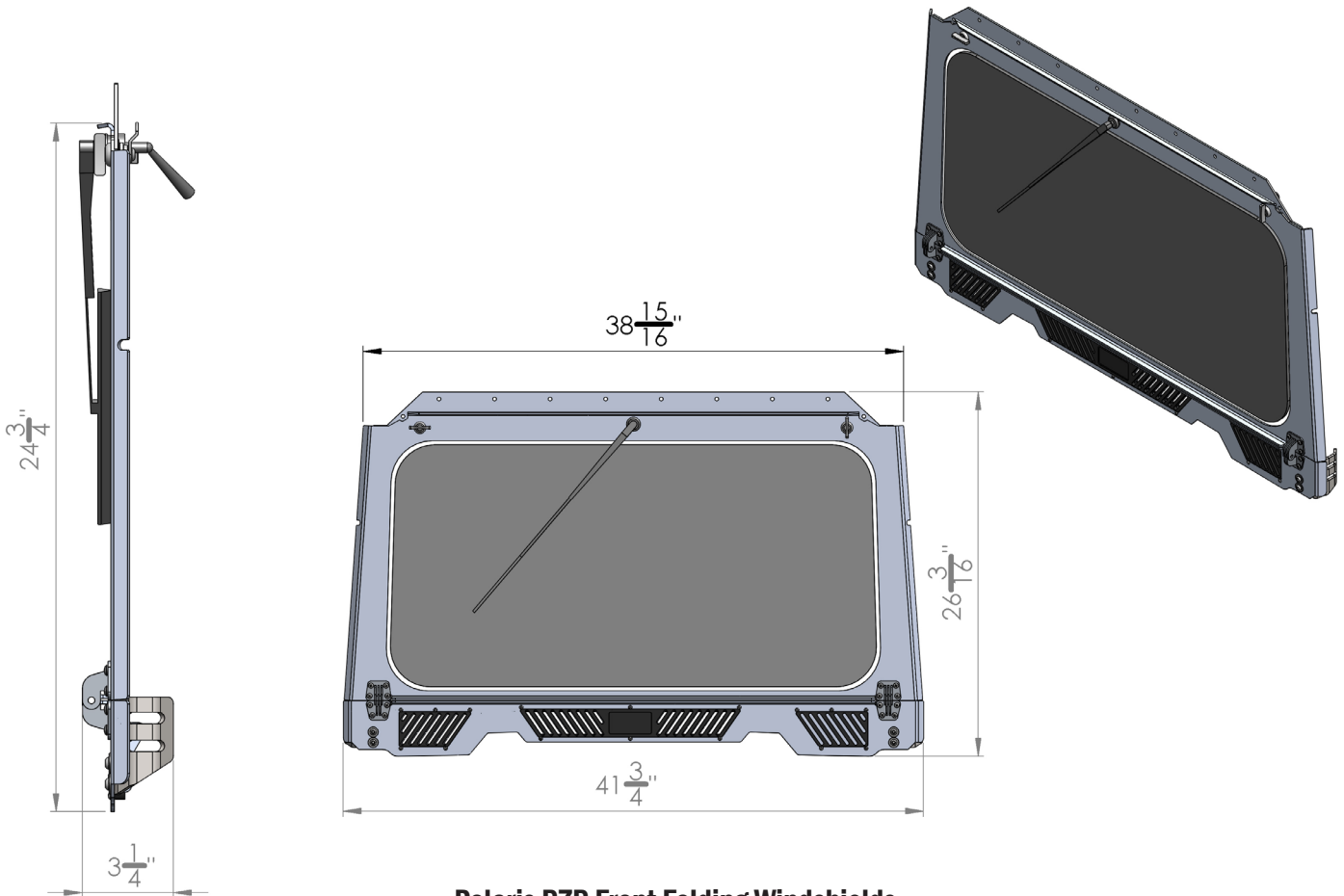

**Polaris RZR Front Folding Windshields**  
**All models (RB04000, RB04021, RB04022, RB04023)**

Copyright 2018 Inventive Edge, LLC dba RazorBack Offroad™ (RBO)  
All information contained within this publication is based on the latest product information at the time of publication. Due to constant improvements in the design and quality of production components, some minor discrepancies may result between the actual parts and the information presented in this publication. Depictions and/or procedures in this publication are intended for reference use only. No liability can be accepted for omissions or inaccuracies. Any reprinting or reuse of the depictions and/or procedures contained within, whether whole or in part, is expressly prohibited.

Printed in U.S.A.  
RBO4000 /RBO4021/RBO4022/RBO4023 - POLARIS RZR 900/1000 FOLDING FRONT WINDSHIELDS  
DOC CONTROL NUMBER RBO0025



PH: (208) 696-7230 FAX: (208) 580-1900

inventive edge, LLC 3190 Industrial way, Mountain Home, ID 83647

RB00025R5